

Trench drain - 39.40" (1000mm) length - KIT

Channel BG-FILCOTEN® self, KIT, nominal width 100 mm / 4"

	Item no.	Product description	Material	Dimensions	Load class (as per EN 1433)	Slot-/Mesh width for grate	Weight	
							Lbs	Kg
○	10710200	BG-FILCOTEN self channel NW 100, KIT, complete with A15 galvanized slotted HEELPROOF grating	FILCOTEN HPC	39.37"/4.80"/3.86" 1000/122/98	A 15 kN	SW0.19" x 3.15" (SW5x80mm)	19	8.6

Specification: BG-FILCOTEN self NW100, 4.80" (122mm) wide, 39.40" (1000mm) long, non-sloped FILCOTEN trench drain system. Body is manufactured from a fibre-reinforced concrete based material. Bodies have interlocking ends, a radiused extract for efficient liquid drainage and a multiple anchoring ribs to securely hold the body into the concrete foundation. Conic vertical outlets are available in 4" (100mm) for corrugated pipe connections. The channel KIT include slotted light duty galvanized steel grate (Load Class A). Grates are secured to the body with a four point self-locking system. End caps and catch basins are also available.

Fonction: Used in residential landscape areas and domestic drainage applications such as domestic driveways and garages with light vehicle access, pedestrian areas, foot paths, patios and similar areas. Ideal for environmentally sensitive areas because the channel body is free of resins, heavy metals, VOC and chemicals. Exceptional adhesion to surrounding concrete foundation due to the concrete composition of the channel body - resulting in a monolithic all concrete installation. Less breakage during transport and installation due to impact resistant, fibre-reinforced, UV resistant high performance concrete material. For light duty applications.

Trench drain 10710200 - KIT

BG-FILCOTEN self NW100

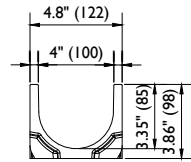
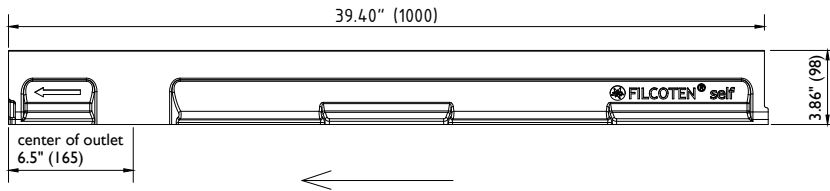

Slotted Grate A15kN: SW5/80 V 17010232

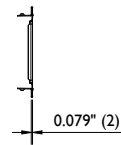
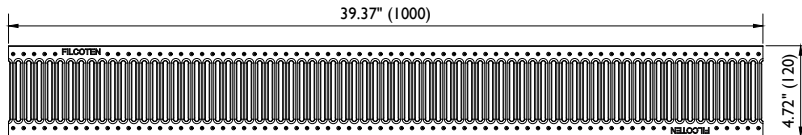

MATERIALS: Channels shall be manufactured from FILCOTEN HPC (High Performance Concrete). Minimum properties of FILCOTEN HPC will be as follows:

Compressive strength according to ASTM C39:	11700 PSI
Flexural strength:	1700 PSI
Free of release agents:	YES
Water absorption sufficient for adhesion with concrete surfaces:	YES
Non flammable:	YES

U/V resistant:	YES
Recyclable 100%:	YES
Dilute acid and alkali resistant:	YES
Frost thaw salt tested as per EN1433 with a test temperature up to -40°C (-40°F):	YES
Resistant to rapid freezing & thawing according to ASTM C666	YES
Resistant to chloride ion penetration according to ASTM C1202	YES
Material free of VOC, biocides, heavy metals:	YES