

Accessories :

Accessories BG-FILCOTEN® self, nominal width 100 mm / 4"

	Item no.	Product description	Material	Dimensions	Load class (as per EN 1433)	Slot-/Mesh width for grate	Weight	
							Lbs	Kg
○	10710290	BG-FILCOTEN self sump unit NW 100, set, L=500mm, complete with A15 galvanized slotted HEELPROOF grating and silt bucket	FILCOTEN HPC	19.38"/4.80"/14.96" 500/122/380	A 15 kN	SW0.19" x 3.15" (SW5x80mm)	39.2	17.8
○	19010221	BG-FILCOTEN self NW100 front-/end cap, closed, galvanized	galvanized steel	0.079"/4.80"/3.74" 2/122/95		N/A	0.2	0.1
○	19010290	BG-FILCOTEN self NW100 conic vertical outlet DN100, for corrugated pipe, galvanized	galvanized steel	19.38"/4.80"/14.96" 500/122/381		N/A	0.7	0.3

1. Sump unit 10710290 – KIT:
 (including: sump unit P/N 10710090, slotted grate P/N 17010233,
 and Silt bucket P/N 22515)

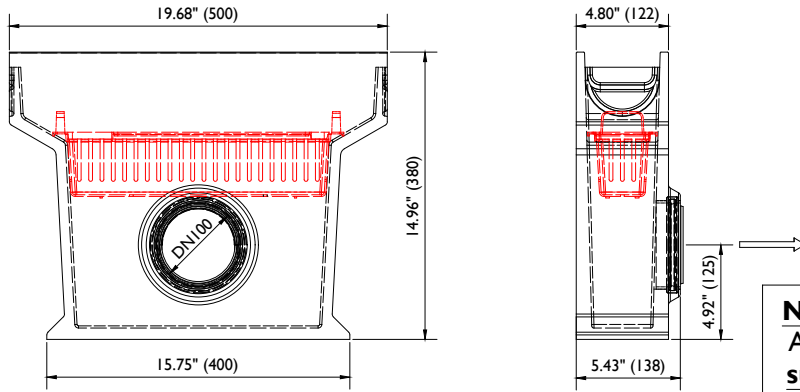

NOTE:
 A standard 'P' trap of 4in
 supplied by others can
 be connected onto the
 sump unit outlet

2. End cap:

19010221

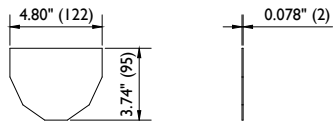

3. Conic vertical outlet:

19010290

