

Caniveau:

FILCOTEN tec LN200 V-E: C250
 BG code V: 10220200 (10220250); 30,2 kg (15,1 kg):
 BG code E: 10220300 (10220350); 30,2 kg (15,1 kg):

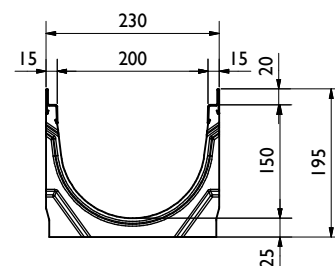

FILCOTEN tec LN200 V-E: C250
 BG code V: 10420200 (10420250); 34 kg (17 kg):
 BG code E: 10420300 (10420350); 34 kg (17 kg):

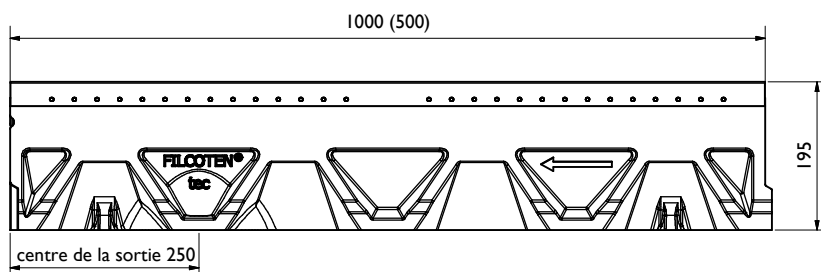
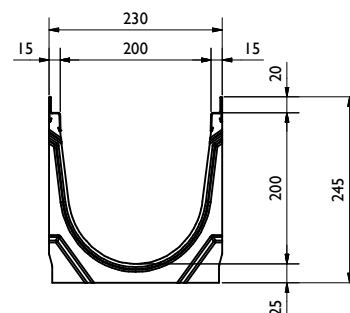
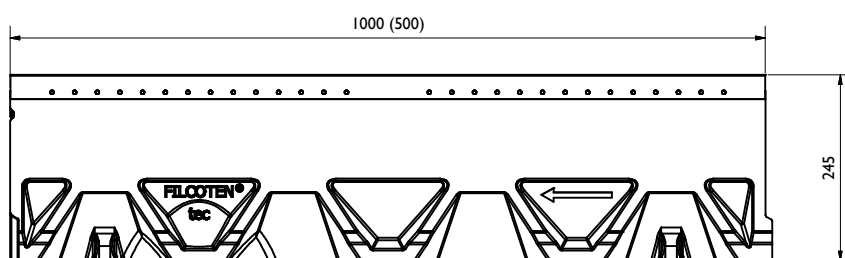

Légende:	
FCT:	FILCOTEN HPC
V:	acier galvanisé
E:	acier inoxydable
G:	fonte ductile
H:	bois

Grilles, couvertures:

grille perforée: Ø6; C250
BG code: V 17020228 (17020229), E 17020328 (17020329); 13,5kg (6,7kg):

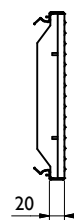
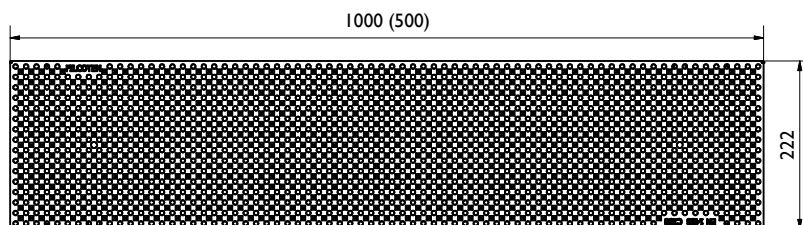

grille caillebotis: LM 30/10; B125
BG code: V 17020220 (17020221), E17020320 (17020321); 6kg (3,1kg):

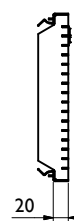
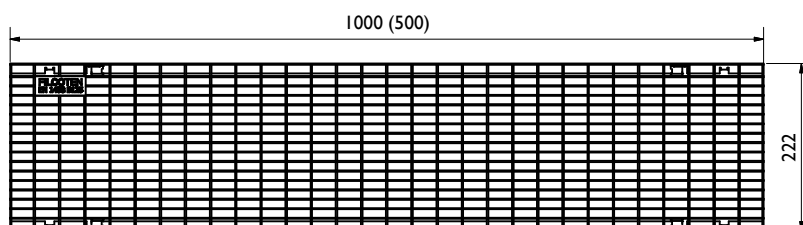

grille caillebotis: LM 30/10; C250
BG code: V 17020222 (17020223), E 17020322 (17020323); 8,8kg (4,5kg):

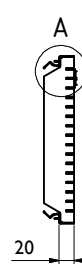
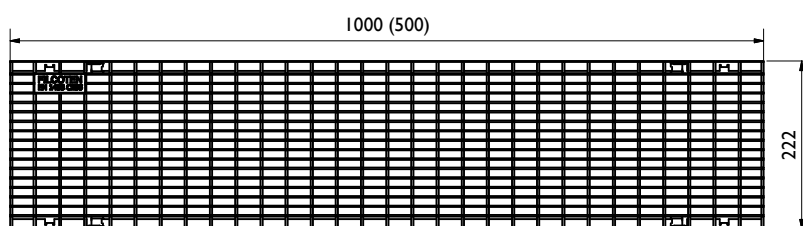

A (1 : 2)



grille à barres longitudinales en fonte ductile: LM 29/13;
C250 BG code: GJS 17020101; 7,3kg:

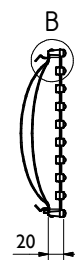
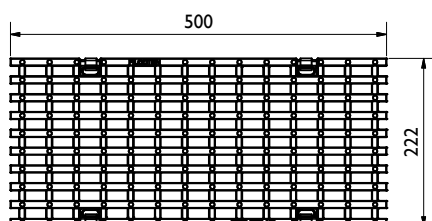

B (1 : 2)



Accessoires:

avaloir, puisard:

incl. panier à sédiment en plastique (22512; 0,7 kg)

BG code: V 10420292; 48,7 kg:

BG code: E 10420392; 48,7 kg:

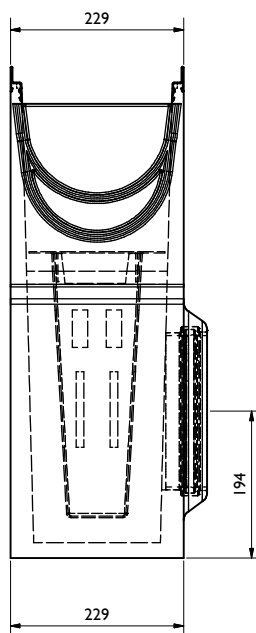
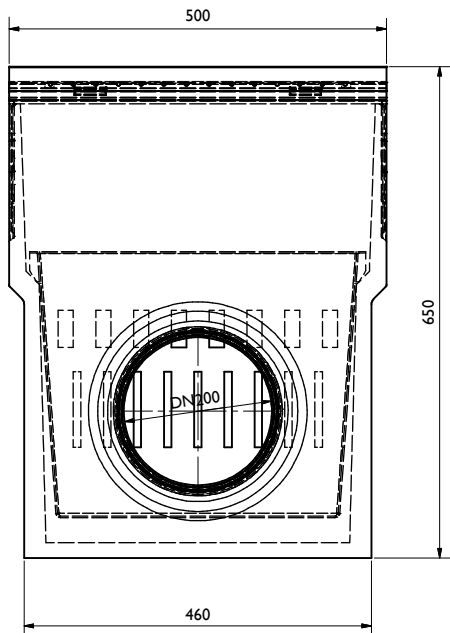

plaque d'about pleine

BG code: V 19020230, E 19020330; 0,8 kg:

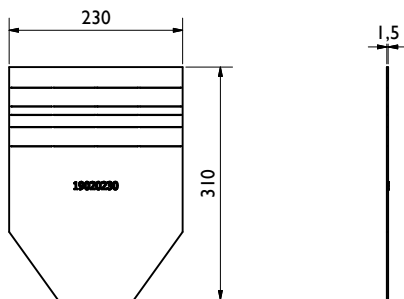

plaque d'about avec sortie DN200

BG code: V 19020231, E 19020331; 1 kg:

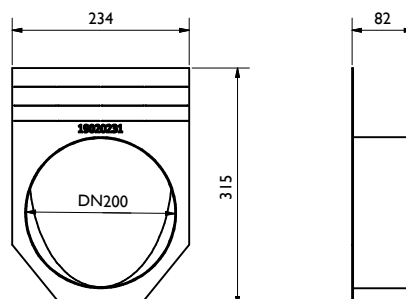

plaque d'about avec sortie DN150

BG code: V 19020232, E 19020332; 0,5 kg:

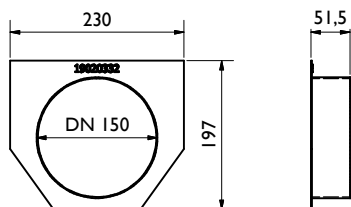

dispositif de verrouillage anti-vandalisme:

BG code: E 32089; 0,1 kg

