

Trench drain body with integral cast iron rails - 39.40" (1000mm) length

Channel body BG-FILCOTEN® pro G NW 200 (8") – extra heavy duty series

	Body part number cast iron rails	Channel type	Slope	Overall body depth		Maximum flow rate			Weight (less grate)	
				E1 (Min.)	E2 (Max.)	GPM *)	LPS *)	CFS *)	Lbs	Kg
○	I0620100	200/0	0 %	10.43" (265 mm)	10.43" (265 mm)	369.3	23.3	0.82	98.77	44.8
○	I0620101	200/1	0.5 %	10.43" (265 mm)	10.63" (270 mm)				99.87	45.3
○	I0620102	200/2	0.5 %	10.63" (270 mm)	10.83" (275 mm)				102.07	46.3
○	I0620103	200/3	0.5 %	10.83" (275 mm)	11.02" (280 mm)				104.28	47.3
○	I0620104	200/4	0.5 %	11.02" (280 mm)	11.22" (285 mm)				106.48	48.3
○	I0620105	200/5	0.5 %	11.22" (285 mm)	11.42" (290 mm)				108.69	49.3
○	I0620161	200/5-0	0 %	11.42" (290 mm)	11.42" (290 mm)	439.1	27.7	0.98	109.79	49.8
○	I0620106	200/6	0.5 %	11.42" (290 mm)	11.61" (295 mm)				110.89	50.3
○	I0620107	200/7	0.5 %	11.61" (295 mm)	11.81" (300 mm)				113.10	51.3
○	I0620108	200/8	0.5 %	11.81" (300 mm)	12.01" (305 mm)				115.30	52.3
○	I0620109	200/9	0.5 %	12.01" (305 mm)	12.20" (310 mm)				117.51	53.3
○	I0620110	200/10	0.5 %	12.20" (310 mm)	12.40" (315 mm)				119.71	54.3
○	I0620162	200/10-0	0 %	12.40" (315 mm)	12.40" (315 mm)	515.1	32.5	1.15	120.81	54.8
○	I0620111	200/11	0.5 %	12.40" (315 mm)	12.60" (320 mm)				123.02	55.8
○	I0620112	200/12	0.5 %	12.60" (320 mm)	12.80" (325 mm)				125.27	56.8
○	I0620113	200/13	0.5 %	12.80" (325 mm)	12.99" (330 mm)				127.51	57.8
○	I0620114	200/14	0.5 %	12.99" (330 mm)	13.19" (335 mm)				129.76	58.9
○	I0620115	200/15	0.5 %	13.19" (335 mm)	13.39" (340 mm)				132.01	59.9
○	I0620116	200/16	0.5 %	13.39" (340 mm)	13.58" (345 mm)				134.26	60.9
○	I0620117	200/17	0.5 %	13.58" (345 mm)	13.78" (350 mm)				136.51	61.9
○	I0620118	200/18	0.5 %	13.78" (350 mm)	13.98" (355 mm)				138.76	62.9
○	I0620119	200/19	0.5 %	13.98" (355 mm)	14.17" (360 mm)				141.01	64.0
○	I0620120	200/20	0.5 %	14.17" (360 mm)	14.37" (365 mm)				143.25	65.0
○	I0620164	200/20-0	0 %	14.37" (365 mm)	14.37" (365 mm)	678.4	42.8	1.51	144.62	65.6

I) With cast-iron rail, tested up to cl. F 900 acc. to EN 1433. Installation according to the manufacturer's installation instructions.

*) GPM = Gallons per minute, LPS = Liters per second, CFS = Cubic feet per second

Specification: BG-FILCOTEN pro-G NW200, 9.37" (238mm) wide, 39.40" (1000mm) long, pre-sloped (0.5%) or neutral BG-FILCOTEN trench drain system. Body is manufactured from a fibre-reinforced concrete based material. Bodies have interlocking ends, a radiused extract for efficient liquid drainage and a multiple anchoring ribs to securely hold the body into the concrete foundation. Each body is manufactured with an integral 0.20" (5mm) thick, extra heavy duty, cast iron rail. End and bottom outlets are available in 8" (200mm) no hub outlet connections. Grate options include extra heavy duty ductile iron (Load Class E), slotted extra heavy duty ductile iron (Load Class F). Grates are secured to the body with a four point bolting system. End caps and catch basins are also available.

Function: Used in commercial areas such as factories, warehouses, parking garages, car dealerships, gas stations, public and residential areas, parks, sports complexes, town squares, railway stations and cycle and foot paths. Ideal for environmentally sensitive areas because the body channels are free of resins, heavy metals, VOC and chemicals. Exceptional adhesion to surrounding concrete foundation due to the concrete composition of the body channels - resulting in a monolithic all concrete installation. Less breakage during transport and installation due to impact resistant, fibre-reinforced, UV resistant concrete material. Extra heavy duty integral galvanized steel rail allows for heavy duty, hard wheel traffic applications.

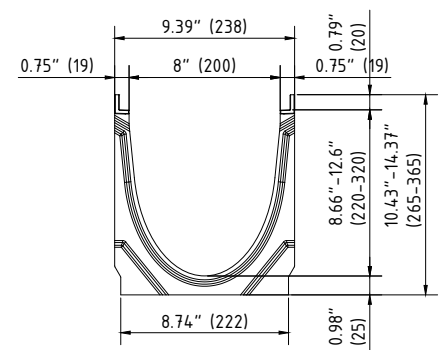
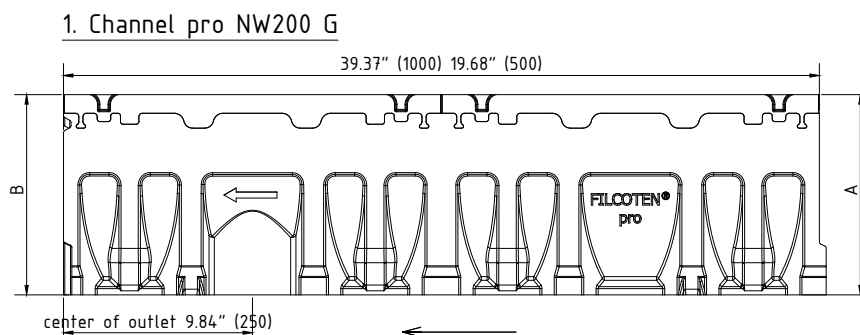

MATERIALS: Channels shall be manufactured from FILCOTEN® HPC (High Performance Concrete). Minimum properties of FILCOTEN® HPC will be as follows:

Compressive strength according to ASTM C39: 11700 PSI
 Flexural strength: 1700 PSI
 Free of release agents: YES
 Water absorption sufficient for adhesion with concrete surfaces: YES
 Non flammable: YES

U/V resistant: YES
 Recyclable 100%: YES
 Dilute acid and alkali resistant: YES
 Frost thaw salt tested as per EN1433 with a test temperature up to -40°C (-40°F): YES
 Resistant to rapid freezing & thawing according to ASTM C666: YES
 Resistant to chloride ion penetration according to ASTM C1202: YES
 Material free of VOC, biocides, heavy metals: YES