

Trench drain body with integral stainless steel rails - 39.40" (1000mm) length

Channel body BG-FILCOTEN® tec E NW 100 (4") – heavy duty series

	Body part stainless steel rails	Channel type	Slope	Overall body depth		Maximum flow rate			Weight (less grate)	
				E1 (Min.)	E2 (Max.)	GPM *)	LPS *)	CFS *)	Lbs	Kg
○	10410300	100/0	0 %	5.31" (135 mm)	5.31" (135 mm)	47.60	3.00	0.11	28.66	13.00
○	10410301	100/1	0.5 %	5.31" (135 mm)	5.51" (140 mm)				29.54	13.40
○	10410302	100/2	0.5 %	5.51" (140 mm)	5.71" (145 mm)				31.08	14.10
○	10410303	100/3	0.5 %	5.71" (145 mm)	5.91" (150 mm)				32.63	14.80
○	10410304	100/4	0.5 %	5.91" (150 mm)	6.10" (155 mm)				33.95	15.40
○	10410305	100/5	0.5 %	6.10" (155 mm)	6.30" (160 mm)				35.05	15.90
○	10410361	100/5-0	0 %	6.30" (160 mm)	6.30" (160 mm)	69.70	4.40	0.16	35.49	16.10
○	10410306	100/6	0.5 %	6.30" (160 mm)	6.50" (165 mm)				36.16	16.40
○	10410307	100/7	0.5 %	6.50" (165 mm)	6.69" (170 mm)				37.04	16.80
○	10410308	100/8	0.5 %	6.69" (170 mm)	6.89" (175 mm)				38.36	17.40
○	10410309	100/9	0.5 %	6.89" (175 mm)	7.09" (180 mm)				39.68	18.00
○	10410310	100/10	0.5 %	7.09" (180 mm)	7.28" (185 mm)				40.79	18.50
○	10410362	100/10-0	0 %	7.28" (185 mm)	7.28" (185 mm)	95.10	6.00	0.21	41.23	18.70
○	10410311	100/11	0.5 %	7.68" (195 mm)	7.87" (200 mm)				45.30	20.55
○	10410312	100/12	0.5 %	7.87" (200 mm)	8.07" (205 mm)				46.08	20.90
○	10410313	100/13	0.5 %	8.07" (205 mm)	8.27" (210 mm)				46.96	21.30
○	10410314	100/14	0.5 %	8.27" (210 mm)	8.46" (215 mm)				50.49	22.90
○	10410315	100/15	0.5 %	8.46" (215 mm)	8.66" (220 mm)				50.93	23.10
○	10410316	100/16	0.5 %	8.66" (220 mm)	8.86" (225 mm)				52.47	23.80
○	10410317	100/17	0.5 %	8.86" (225 mm)	9.05" (230 mm)				53.13	24.10
○	10410318	100/18	0.5 %	9.05" (230 mm)	9.25" (235 mm)				59.30	26.90
○	10410319	100/19	0.5 %	9.25" (235 mm)	9.45" (240 mm)				61.73	28.00
○	10410320	100/20	0.5 %	9.45" (240 mm)	9.65" (245 mm)				61.07	27.70
○	10410364	100/20-0	0 %	9.65" (245 mm)	9.65" (245 mm)	152.20	9.60	0.34	69.90	31.70

*) GPM = Gallons per minute, LPS = Liters per second, CFS = Cubic feet per second

* Note 1: Load class D and E is attainable in a full concrete base - Installation must be conform to manufacturer's installation details for BG-FILCOTEN tec-V class D and E.

* Note 2: Not for use on highways.

Specification: BG-FILCOTEN tec-E NW100, 5.12" (130mm) wide, 39.40" (1000mm) long, pre-sloped (0.5%) or neutral BG-FILCOTEN trench drain system. Body is manufactured from a fibre-reinforced concrete based HPC material. Bodies have interlocking ends, a radiused extract for efficient liquid drainage and a multiple anchoring ribs to securely hold the body into the concrete foundation. Each body is manufactured with an integral 0.08" (2mm) thick, extra heavy duty stainless steel rail. End and bottom outlets are available in 4" (100mm) no hub outlet connections. Grate options include extra heavy duty ductile iron (Load Class C), slotted and perforated heavy duty galvanized steel (Load Class A and C), mesh grating galvanized steel (Load Class B and C), and plastic composite grating (Load Class B and C), Slot Tops units (Load Class B - D). Decorative grates are available. Grates are secured to the body with a four point self-locking system. Catch basins and others accessories are also available.

Function: Used in commercial areas such as factories, warehouses, parking garages, car dealerships, gas stations, public and residential areas, parks, sports complexes, town squares, railway stations and cycle and foot paths. Ideal for environmentally sensitive areas because the body channels are free of resins, heavy metals, VOC and chemicals. Exceptional adhesion to surrounding concrete foundation due to the concrete composition of the body channels - resulting in a monolithic all concrete installation. Less breakage during transport and installation due to impact resistant, fibre-reinforced, UV resistant concrete material. Extra heavy duty integral stainless steel rail allows for heavy duty, hard wheel traffic applications

tec NW100 E 10410300

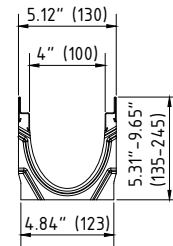
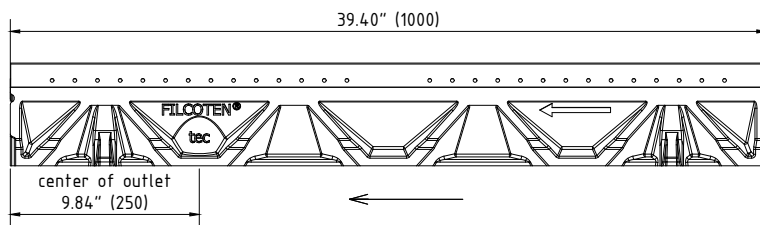

MATERIALS: Channels shall be manufactured from FILCOTEN® HPC (High Performance Concrete). Minimum properties of FILCOTEN® HPC will be as follows:

Compressive strength according to ASTM C39:	11700 PSI
Flexural strength:	1700 PSI
Free of release agents:	YES
Water absorption sufficient for adhesion with concrete surfaces:	YES
Non flammable:	YES

U/V resistant:	YES
Recyclable 100%:	YES
Dilute acid and alkali resistant:	YES
Frost thaw salt tested as per EN1433 with a test temperature up to -40°C (-40°F):	YES
Resistant to rapid freezing & thawing according to ASTM C666	YES
Resistant to chloride ion penetration according to ASTM C1202	YES
Material free of VOC, biocides, heavy metals:	YES