

Plattenbelag / flag pavement

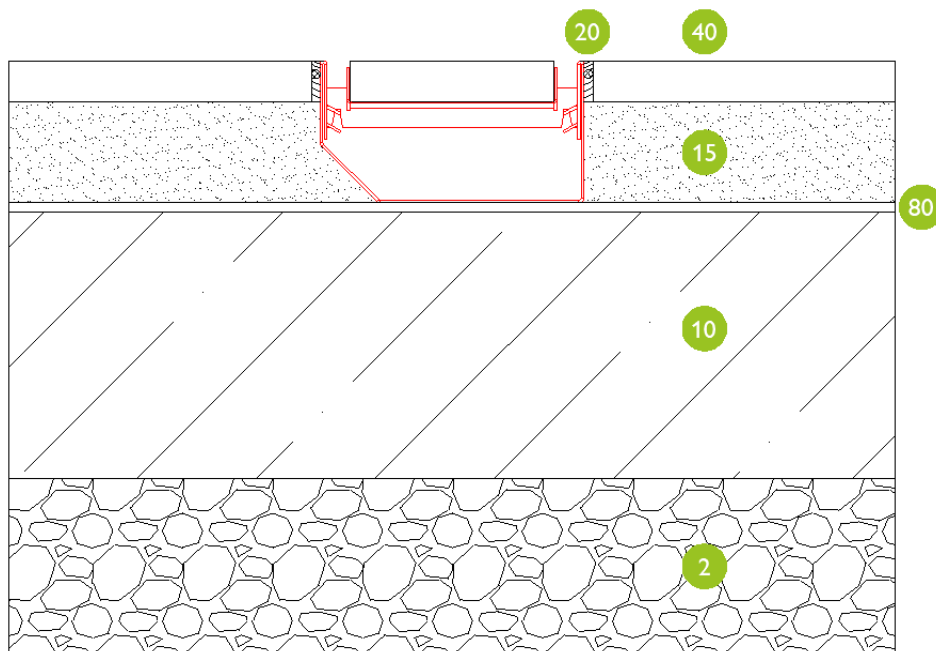

Pflastersteine / paving stones

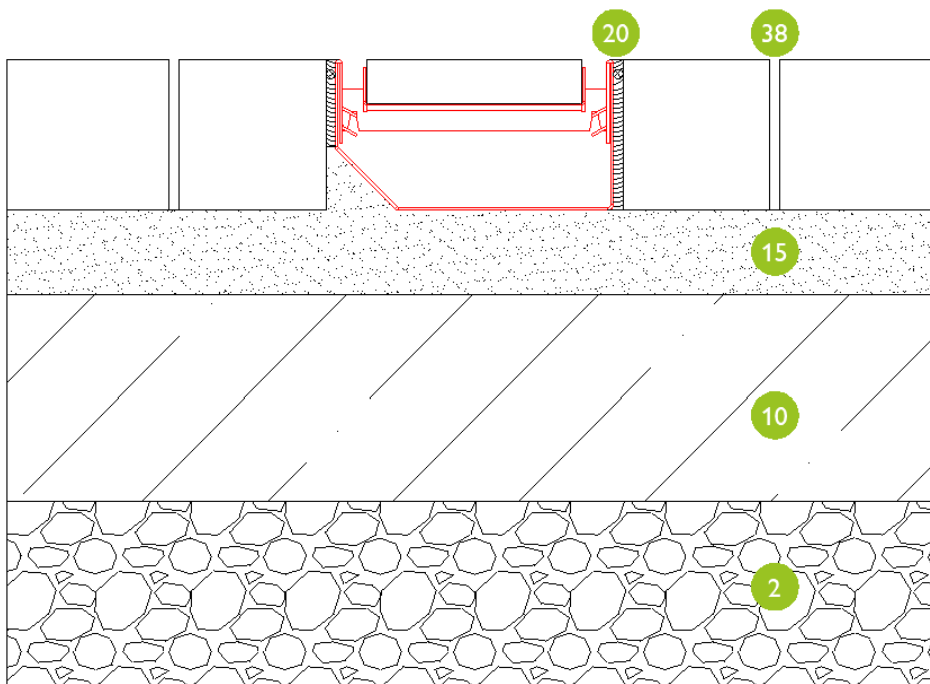

Legende / key:

- | | | | |
|-----|---|-----|---|
| 2. | tragfähige Schotter-
schicht /
load-bearing gravel
layer | 20. | dauerelastische Ver-
fugung /
permanently elastic
seal |
| 10. | Betonfundament /
concrete foundation | 38. | Pflastersteine /
paving stones |
| 15. | Drainagebeton /
drainage concrete | 40. | Plattenbelag /
paving |
| | | 80. | Abdichtungsfolie /
sealing foil |