

auf Betonplatte / on concrete plate

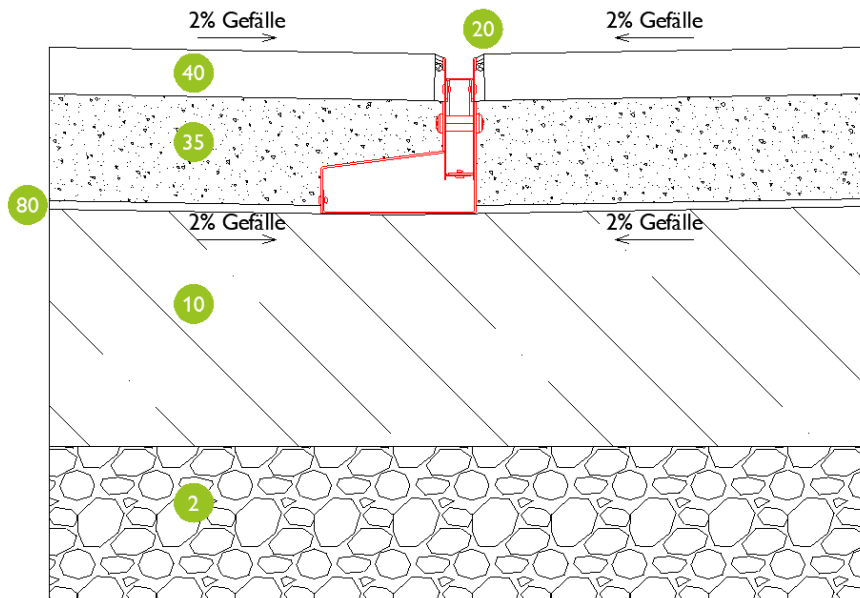

auf Dämmung / on insulation

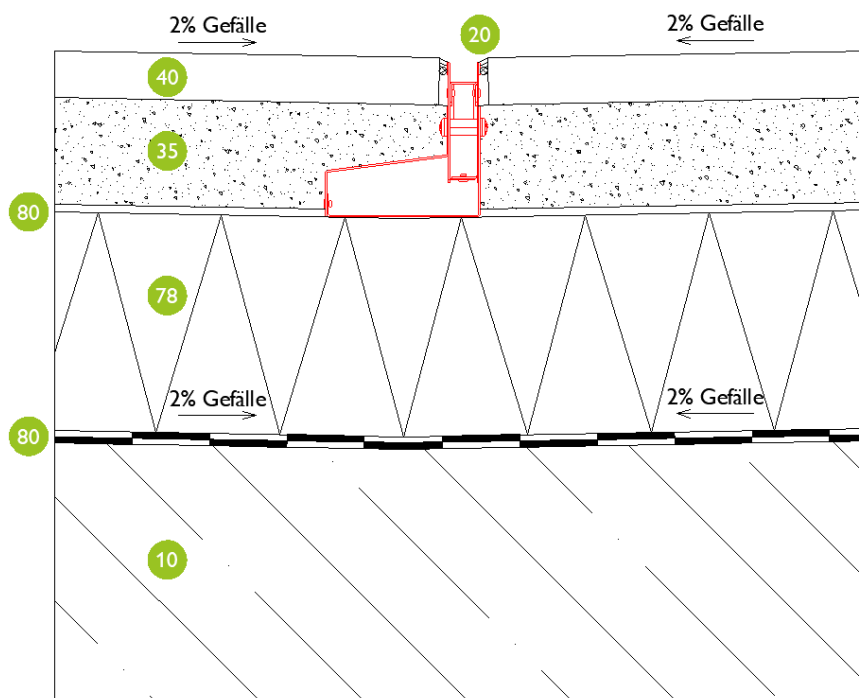

Legende / key:

- | | | | |
|-----|---|-----|-----------------------------------|
| 2. | tragfähige Schotterschicht /
load-bearing gravel layer | 35. | Splittbett / grit bed |
| 10. | Betonfundament / concrete foundation | 78. | Wärmedämmung / thermal insulation |
| 20. | dauerelastische Verfungung /
permanently elastic seal | 80. | Abdichtungsfolie / sealing foil |