

Rinne / channel:

FILCOTEN tec NW150 V-E: C250
BG code: siehe Tabelle / see table

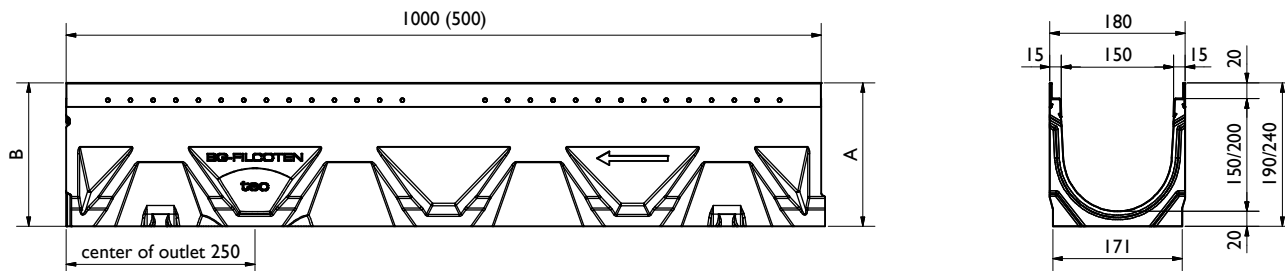

Rinne / channel - Maße / dimensions [mm]						
BG code V	BG code E	Typ	Höhe A height A	Höhe B height B	Länge length	Gewicht weight V/E [kg]
10415200	10415300	0	190	190	1000	22,2
10415250	10415350	0 (0,5m)	190	190	500	11,2
10415262	10415362	10-0	240	240	1000	28,2

Legende / explanation:	
V:	verzinkter Stahl / galvanized steel
E:	Edelstahl / stainless steel
G:	Gußeisen / ductile iron
H:	Holz / wood

Roste, Abdeckungen / grates, covers:

Gitterrost / Mesh grating: MW 30/10; B125
BG code: V 17015220 (17015221); 4,6 kg (2,4 kg):

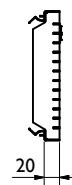
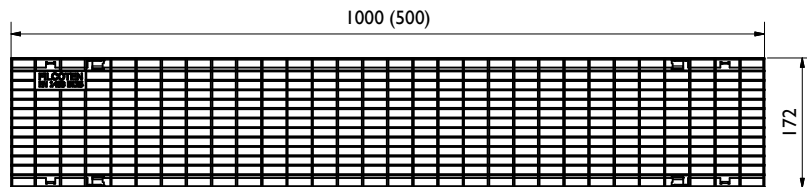

Gitterrost/ Mesh grating: MW: 30/10; C250
BG code: V 17015222 (17015223), E 17015322 (17015323); 6,9 kg (3,6 kg):

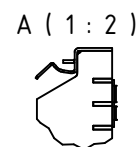
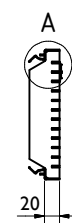
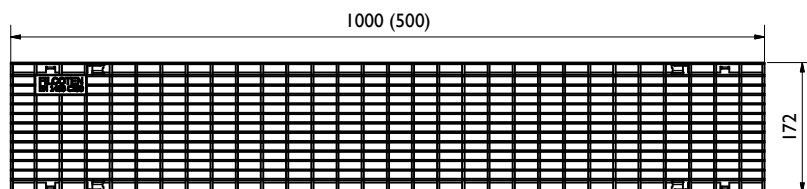

Lochrost / Perforated grating: dm: 6; C250
BG code: V 17015228 (17015229), E 17015328 (17015329); 7 kg (3,5 kg):

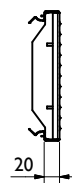
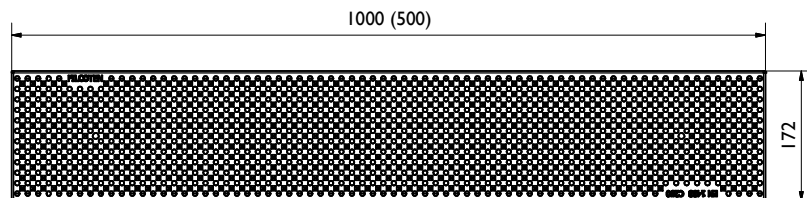

Gußrost / Ductile iron grating: MW 29/13; C250
BG code: GJS 17015101; 4,9 kg:

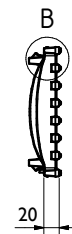
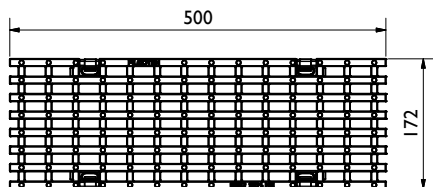

Gußrost / Ductile iron grating: SW 10/150; B125
BG code: GJS 17015111; 4,5 kg:

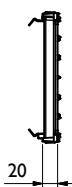
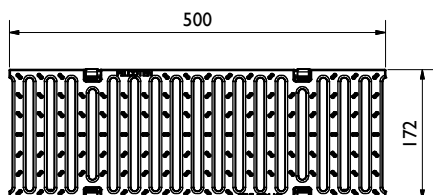

Schlitzaufsatz / slot top NW 150:

Schlitzaufsatz SW 12,5mm, SH 110, C250
BG code: V 17115243 (17115244), E 17115343 (17115344); 6,7 kg (3,3 kg):

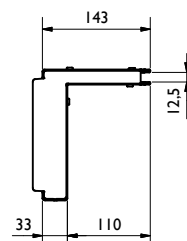
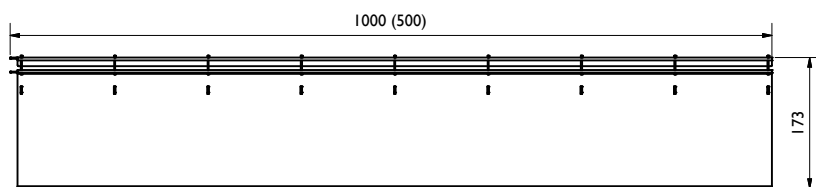

Revisionschacht SW 12,5mm, SH 110, C250
BG code: V 17115281, E 17115381; 5,9 kg:

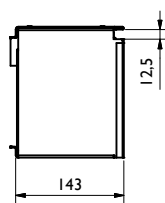
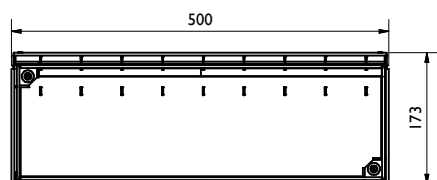

Zubehör / accessory:

Bauzeitabdeckung / construction time barrier
BG code: H 37962; 0,1 kg:

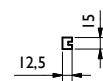
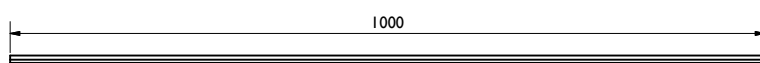

Abhebegriff / opening tool
BG code: V 13399; 0,1 kg:



Design-Schlitzaufsatz / decorative-slot top NW 150:

Schlitzaufsatz 2S / slot top 2S, Heelproof, SW 2x6mm, SH 110, C250
BG code: V 17116204 (17116205), E 17116304 (17116305); 7,2 kg (3,6 kg):

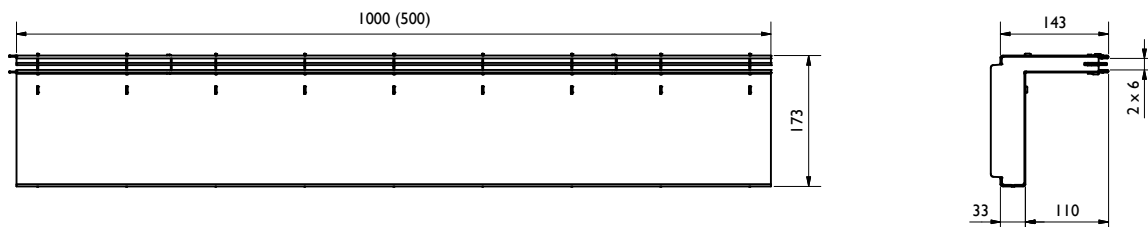

Revisionssschacht 2S / revision shaft 2S, Heelproof, SW 2x6mm, SH 110, C250
BG code: V 17116206, E 17116306; 6,8 kg:

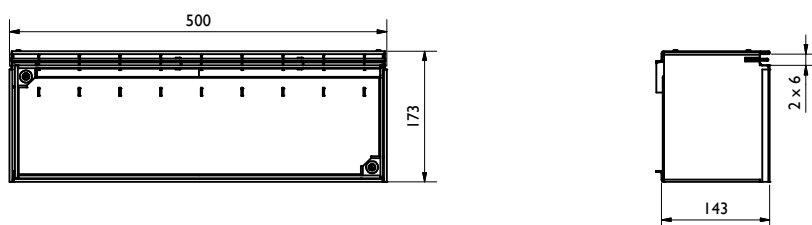

Schlitzaufsatz 3S / slot top 3S, Heelproof, SW 3x6mm, SH 110, C250
BG code: E 17116307 (17116308); 7,9 kg (4 kg):

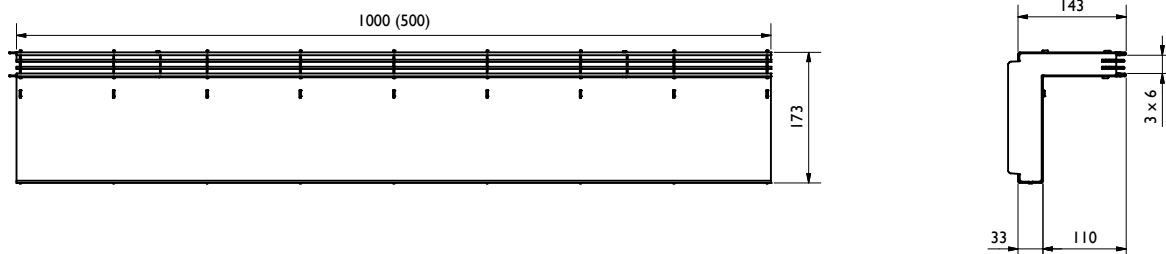

Revisionssschacht 3S / revision shaft 3S, Heelproof, SW 3x6mm, SH 110, C250
BG code: E 17116309; 6,8 kg:

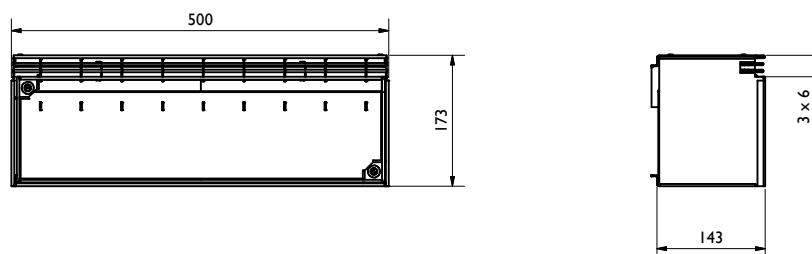

Abdeckband weiß / cover tape white
BG code: 37963

50mm Breite / width
33m Länge pro Rolle / length per roll

Zubehör / accessories:

Sinkkasten / Sump unit:
inkl. Schlammeimer / incl. silt bucket (22516; 0,3 kg)
BG code: V 10415292, E 10415392; 40,3 kg:

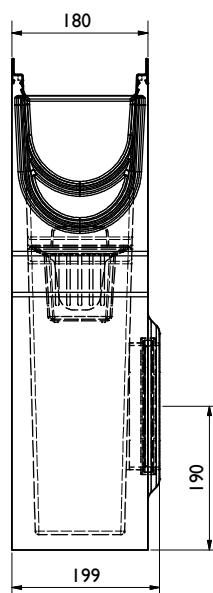
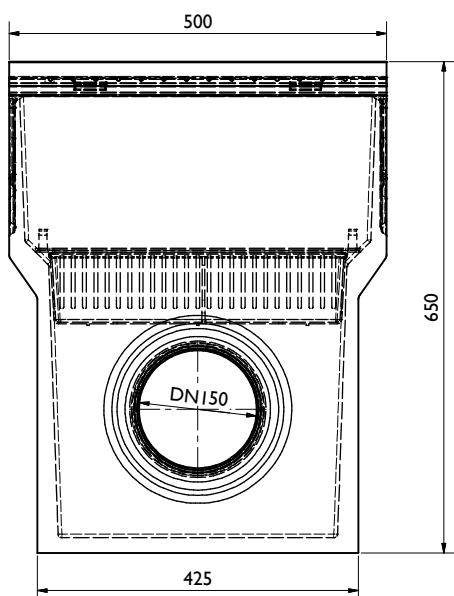

Stirn-/ Endplatte / End cap:
BG code: V 19015230, E 19015330; 0,5 kg

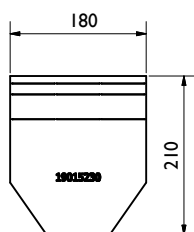

SEndplatte mit Ablauf / end cap with outlet
BG code: V 19015231, E 19015331; 0,6 kg:

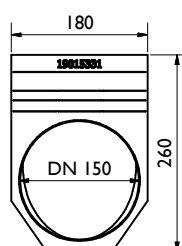

Vandalismus Verriegelung / Anti-vandalism locking device:
BG code: E 32088; 0,1 kg

