

Rinnen/Channel:

FCT pro mini: NW100

BG code: V 10510200 H60; 9,1 kg; V 10510201 H80; 10,7 kg;

BG code: E 10510300 H60; 9,1 kg; E 10510301 H80; 10,7 kg;

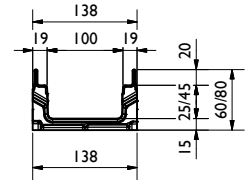
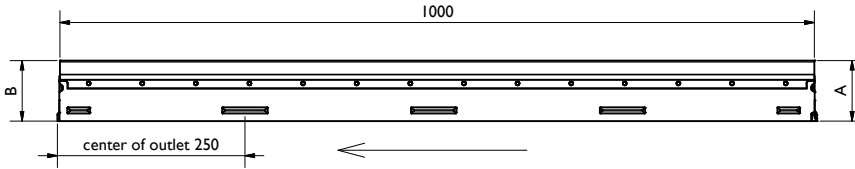

FCT pro mini: NW100

BG code: G 10510101 H80; 11,1 kg;

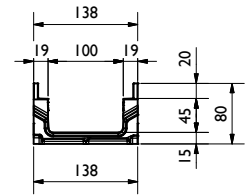
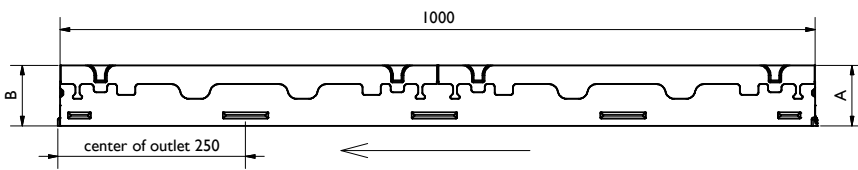

FCT pro mini: NW100

BG code: P 10510401 H80; 9 kg;

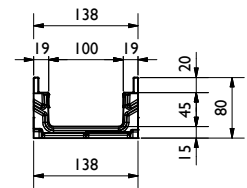
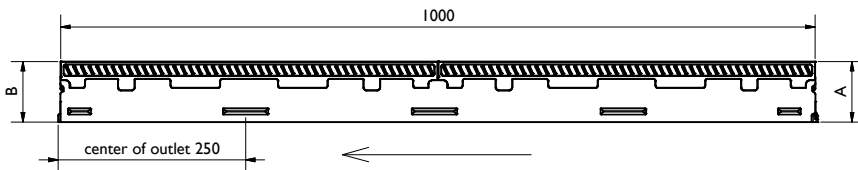

FCT pro mini: NW100

BG code: P 10510400 H70; 10,2 kg

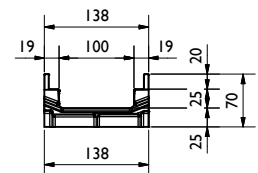
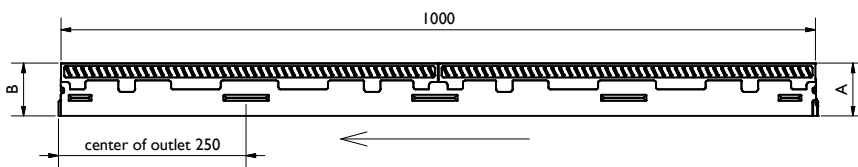

Rinne / channel - Maße / dimensions [mm]										
BG code V	BG code E	BG code G	BG code P	Typ	Höhe A height A	Höhe B height B	Länge length	Gewicht weight V/E [kg]	Gewicht weight G [kg]	Gewicht weight P [kg]
10510200	10510300	-	-	mini 60	60	60	1000	9,1	-	-
-	-	-	10510400	mini 70	70	70	1000	-	-	10,2
10510201	10510301	10510101	10510401	mini 80	80	80	1000	10,7	11,1	9

Legende / explanation:	
FCT:	FILCOTEN HPC
V:	verzinkter Stahl / galvanized steel
E:	Edelstahl / stainless steel
G:	Gußeisen / ductile iron
H:	Holz / wood

Roste, Abdeckungen / grates, covers:

Gitterrost / Mesh grating: MW 30/10, C250
BG code: V 17010222 (17010223), E 17010322 (17010323); C250 3,3 kg (1,6 kg):

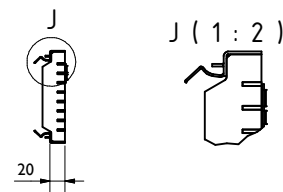
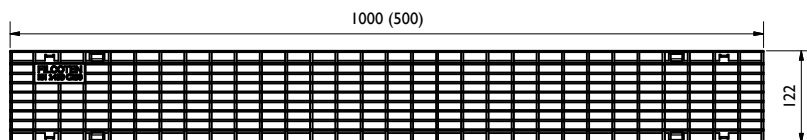

Gitterrost / Mesh grating: MW 25/10, D400
BG code: V 17010226 (17010227), E 17010326 (17010327); D400 7,4 kg (3,7 kg):

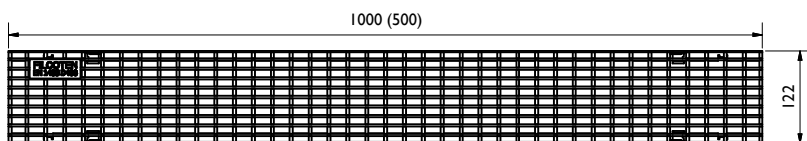

Stegrost / Slotted grating: SW 8/80, C250
BG code: V 17010206 (17010207), E 17010306 (17010307); C250 4,5 kg (2,2 kg):

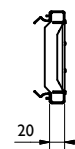
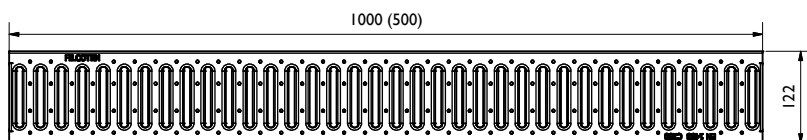

Lochrost / Perforated grating: Ø 6 mm, C250
BG code: V 17010228 (17010229), E 17010328 (17010329); 3,3 kg (1,7 kg):

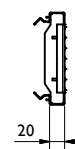
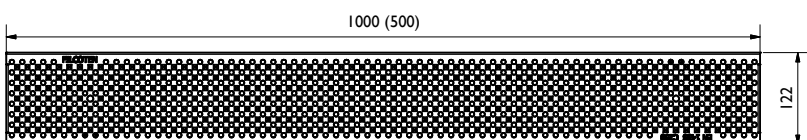

Roste, Abdeckungen / grates, covers:

Kunststoffrost / Plastic grating: COMBee; Ø7,3; C250
BG code: PA 17010402; 1,1 kg:

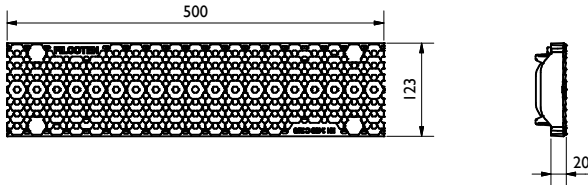

Kunststoff-Stegrost / plastic slotted grating: SW 8/40; C250
BG code: PA 17010404; 1,1 kg:

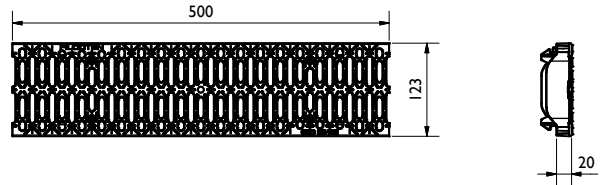

Kunststoff-Stegrost / plastic slotted grating: SW 8/40; B125
BG code: PA 17010403; 1,1 kg:

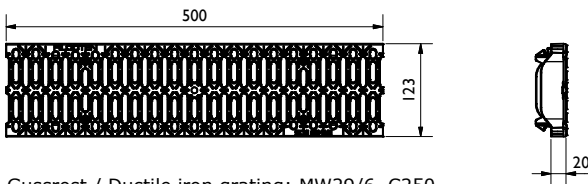

Gußrost / Ductile iron grating: MW 29/13, C250
BG code: GJS 17010101; 3,2 kg:

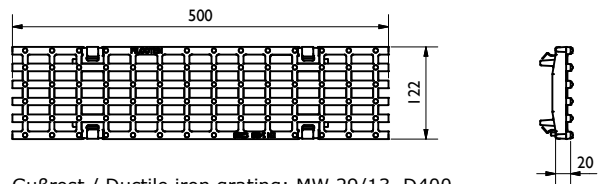

Gussrost / Ductile iron grating: MW29/6, C250
BG code: GJS 17010106; 3,6 kg:

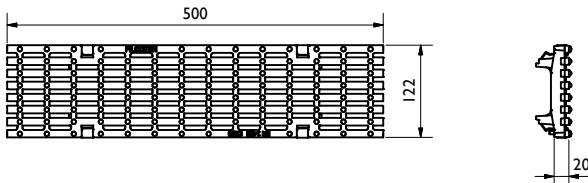

Gußrost / Ductile iron grating: MW 29/13, D400
BG code: GJS 17010104; 3,4 kg:

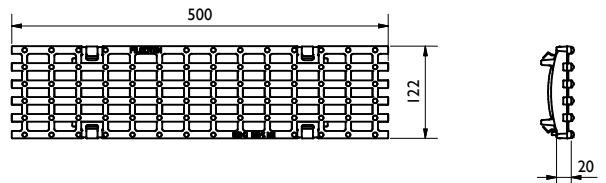

Guß-Stegrost / Ductile iron slotted grating: SW 14/100, E600
BG code: GJS 17010105; 3,8 kg:

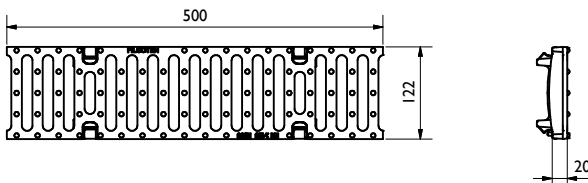

Guß-Designrost / Ductile iron design grating: LINEAR, D400
BG code: GJS 17010188; 4,7 kg:

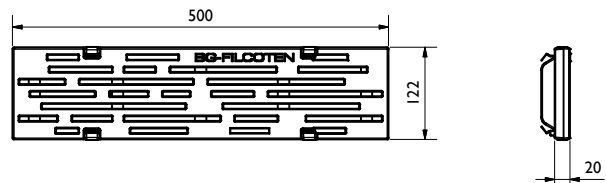

Guß-Designrost / Ductile iron design grating: KIARO, D400
BG code: GJS 17010183; 4,1 kg:

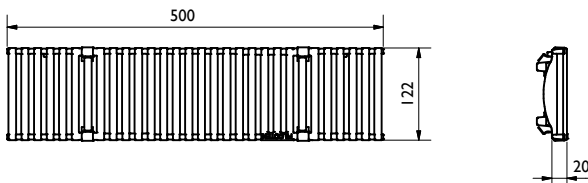

Guß-Designrost / Ductile iron design grating: VIA, D400
BG code: GJS 17010184; 3,6 kg:

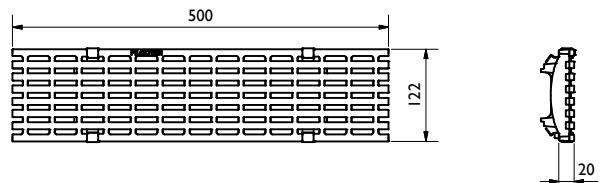

Guß-Designrost / Ductile iron design grating: RIVER, D400
BG code: GJS 17010185; 3,8 kg:

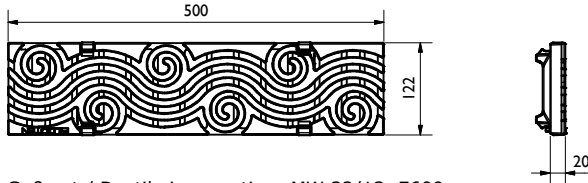

Guß-Designrost / Ductile iron design grating: VILLE, E600
BG code: GJS 17010180; 5,2 kg:

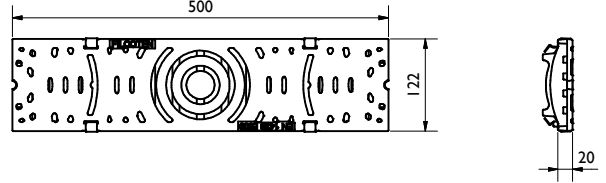

Gußrost / Ductile iron grating: MW 22/13, E600
BG code: GJS 17010103; 4,2 kg:
4-fach verschraubbar/4-times bolted

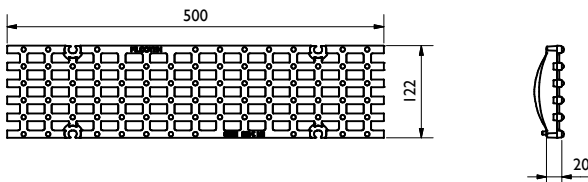

Guß-Stegrost / Ductile iron slotted grating: SW 14/100, D400
BG code: GJS 17010108; 3,8 kg:
4-fach verschraubbar/4-times bolted

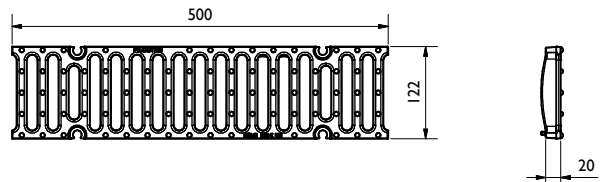

Zubehör / accessories:

Sinkkasten / Sump unit:
inkl. Schlammemeier / incl. silt bucket (22515; 0,2 kg)
BG code: V 10610292, E 10610392; 32,6 kg

Sinkkasten / Sump unit:
inkl. Schlammemeier / incl. silt bucket (22515; 0,2 kg)
BG code: G 10610192; 33,1 kg

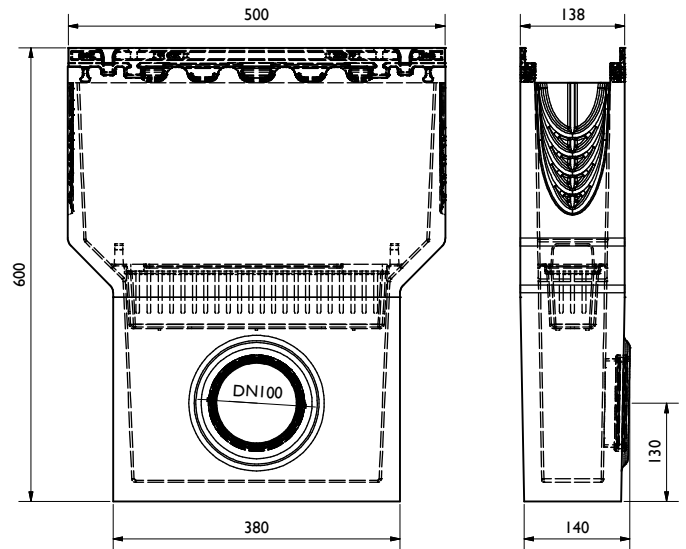
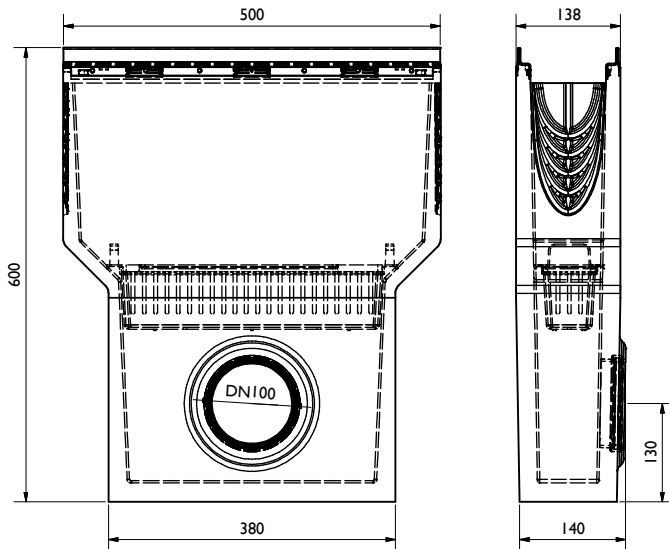

Sinkkasten / Sump unit:
inkl. Schlammemeier / incl. silt bucket (22515; 0,2 kg)
BG code: P 10610492; 32 kg

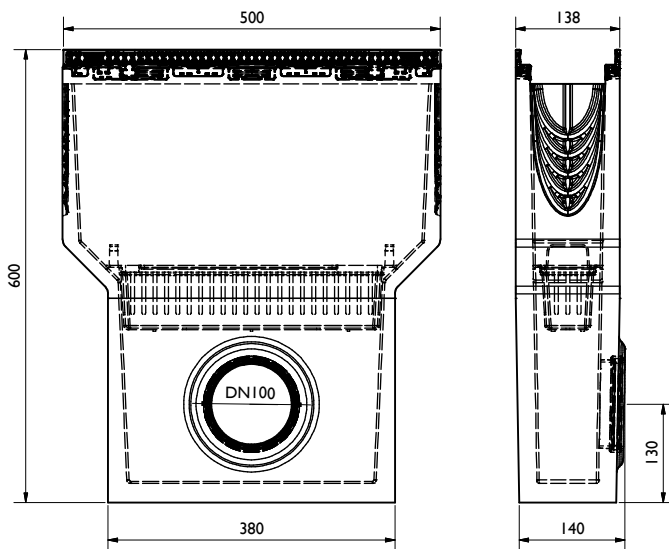

Stirn-/Endplatte / Front-/End cap:
BG code: V 19010200, E 19010300; 0,1 kg:

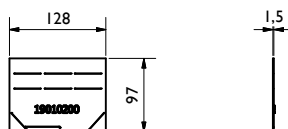

Geruchsverschluss für Bodenablauf / Drain trap for bottom outlet:
BG code: PVC 30019; 0,2 kg:

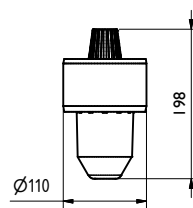

Vandalismus Verriegelung / Anti-vandalism locking device
BG code: E 32087; 0,1 kg:

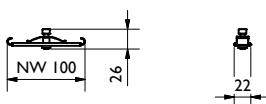

Verschraubungsmaterial / Bolting material:
BG code: V 32103; BG code: E 32109:

