

## Asphalt / asphalt: Kl. / cl. A - C

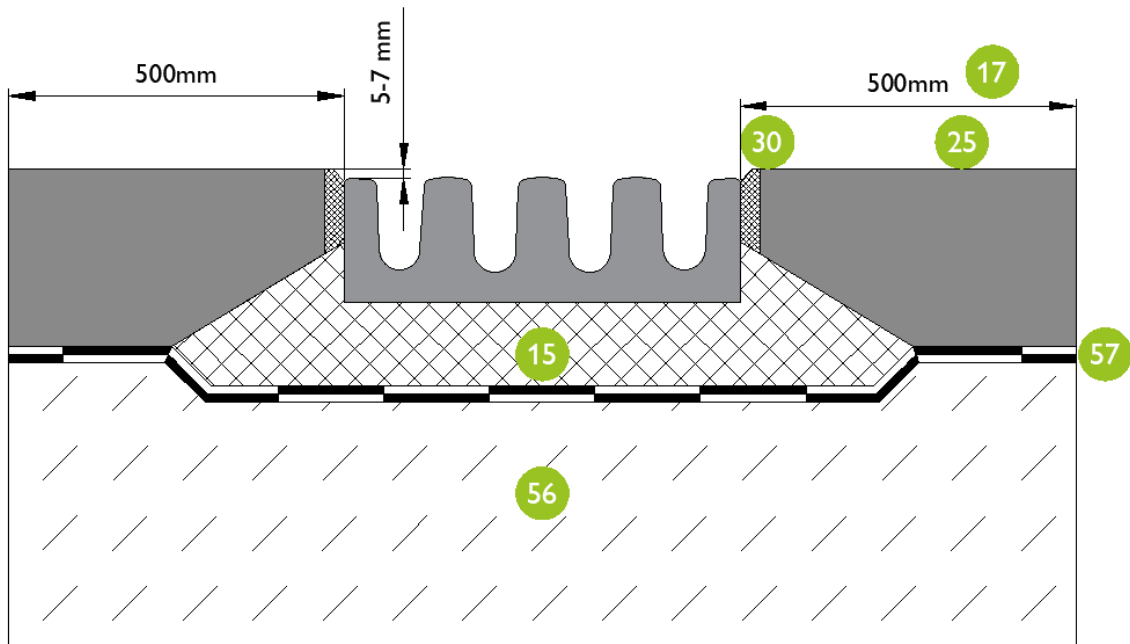

## Asphalt / asphalt: Kl. / cl. A - C

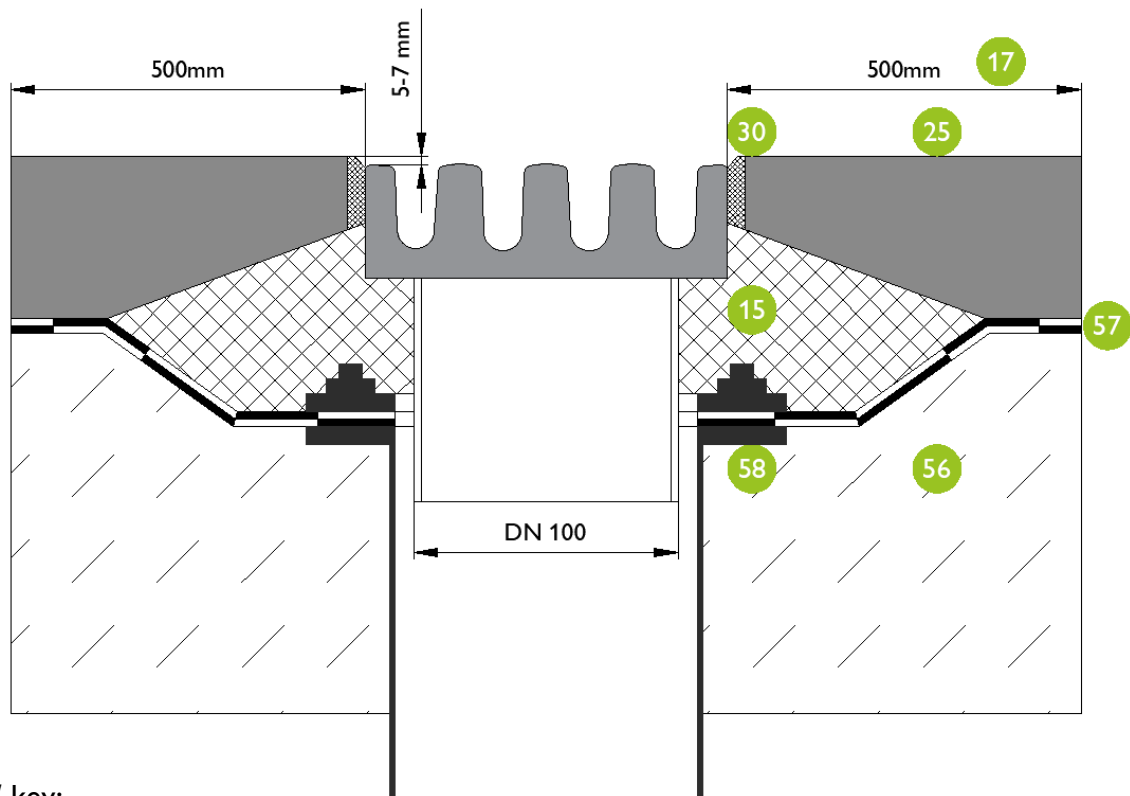

### Legende / key:

- |     |  |     |   |
|-----|--|-----|---|
| 15. | Drainagebeton / drainage concrete                                  | 56. | Stahl-Betondecke / steel-reinforced concrete surface        |
| 17. | Verdichtung mit Rüttelplatte /<br>compression with vibrating plate | 57. | bituminöse Abdichtungsebene /<br>bituminous sealing layer   |
| 25. | Asphalt / asphalt  | 58. | Rohrdurchführung mit Klemmflansch /<br>pipes with trim ring |
| 30. | bituminöses Fugenband / bituminous sealing tape                    |     |   |

### Guss-Asphalt / melted-asphalt: Kl. / cl. A - C

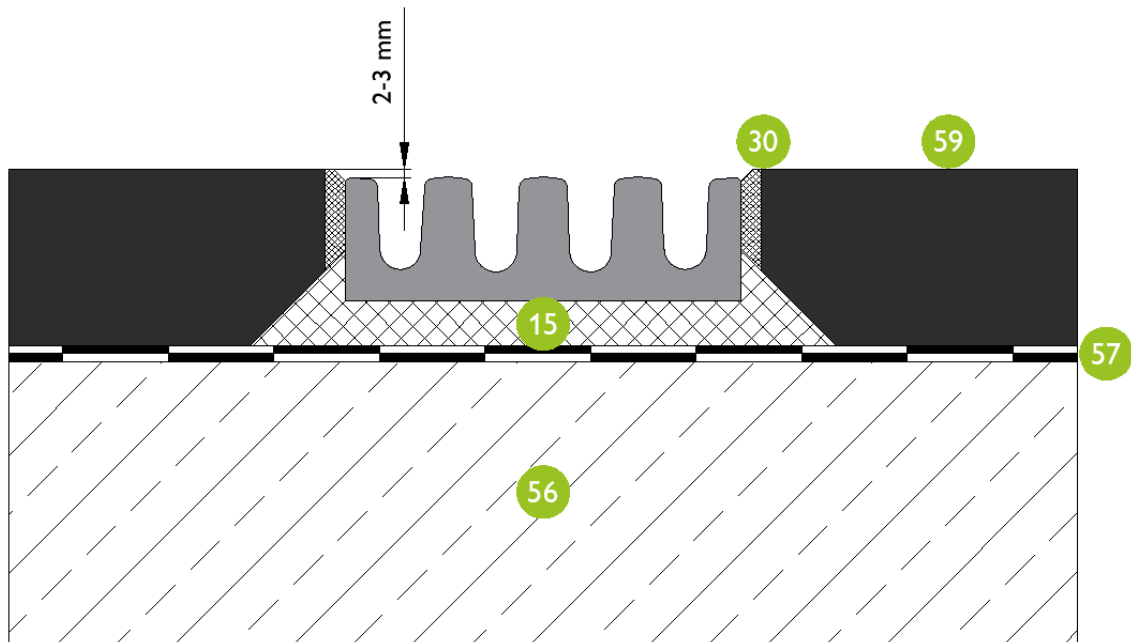

### Guss-Asphalt / melted-asphalt: Kl. / cl. A - C

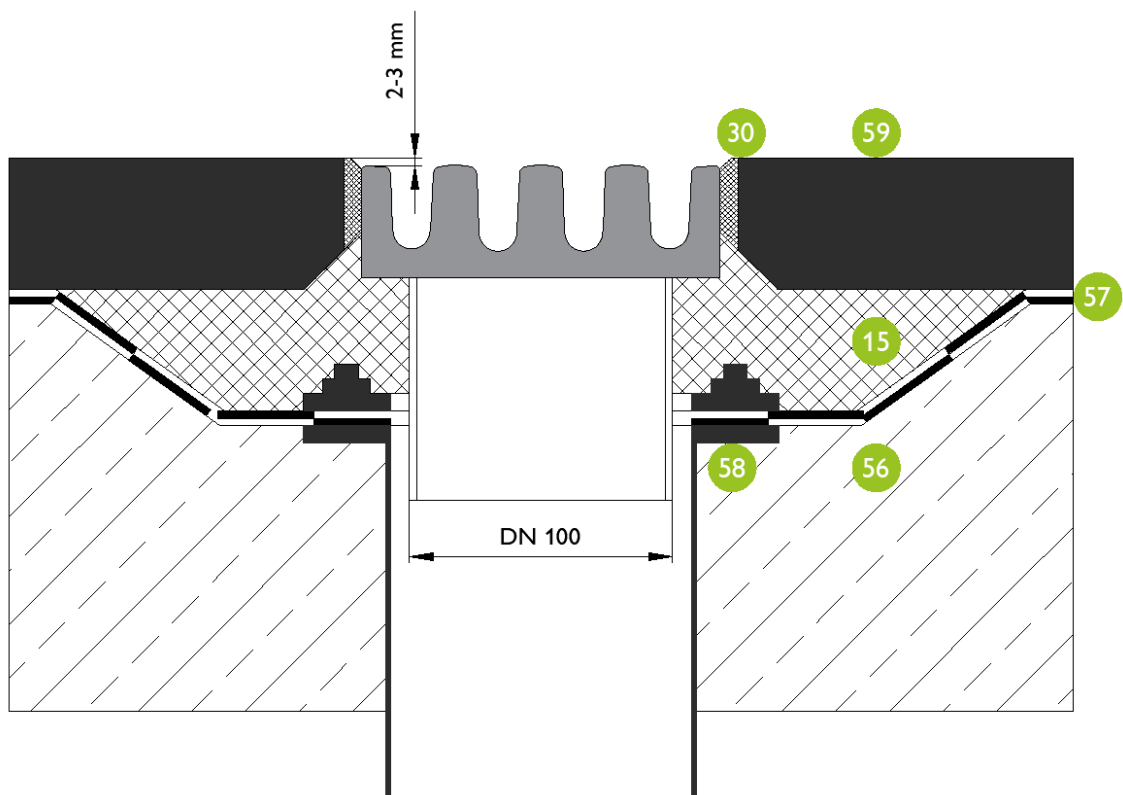

Legende / key:

- |     |  |     |  |
|-----|--|-----|--|
| 15. | Drainagebeton / drainage concrete                    | 57. | bituminöse Abdichtungsebene / bituminous sealing layer   |
| 30. | bituminöses Fugenband / bituminous sealing tape      | 58. | Rohrdurchführung mit Klemmflansch / pipes with trim ring |
| 56. | Stahl-Betondecke / steel-reinforced concrete surface | 59. | Gussasphalt / mastic asphalt                             |

### Beton beschichtet / concrete coated: Kl. / cl. A - C

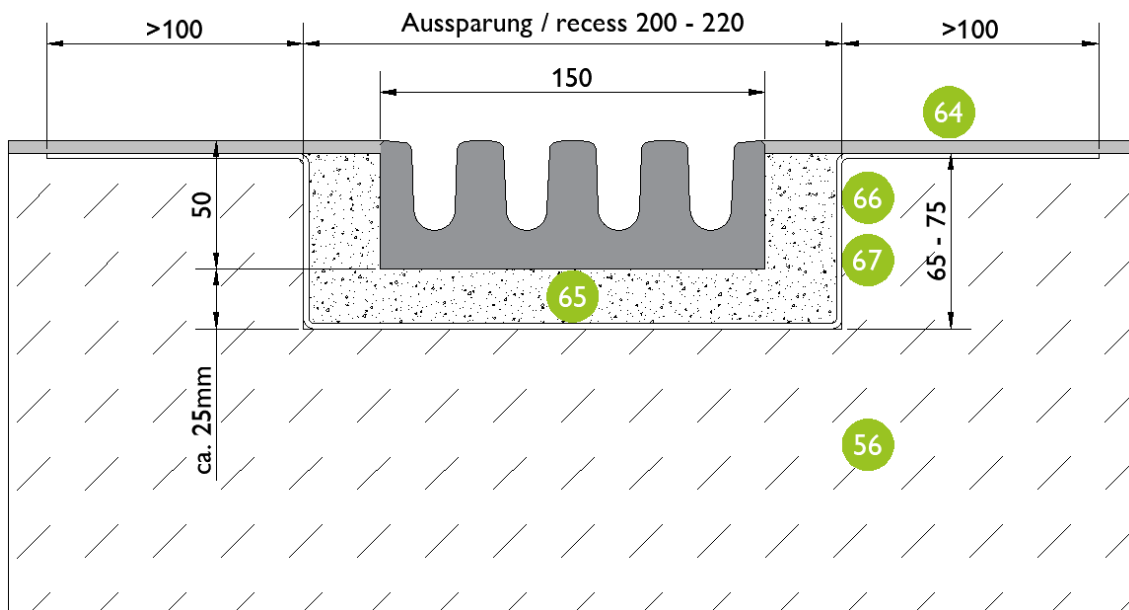

### Beton beschichtet / concrete coated: Kl. / cl. A - C

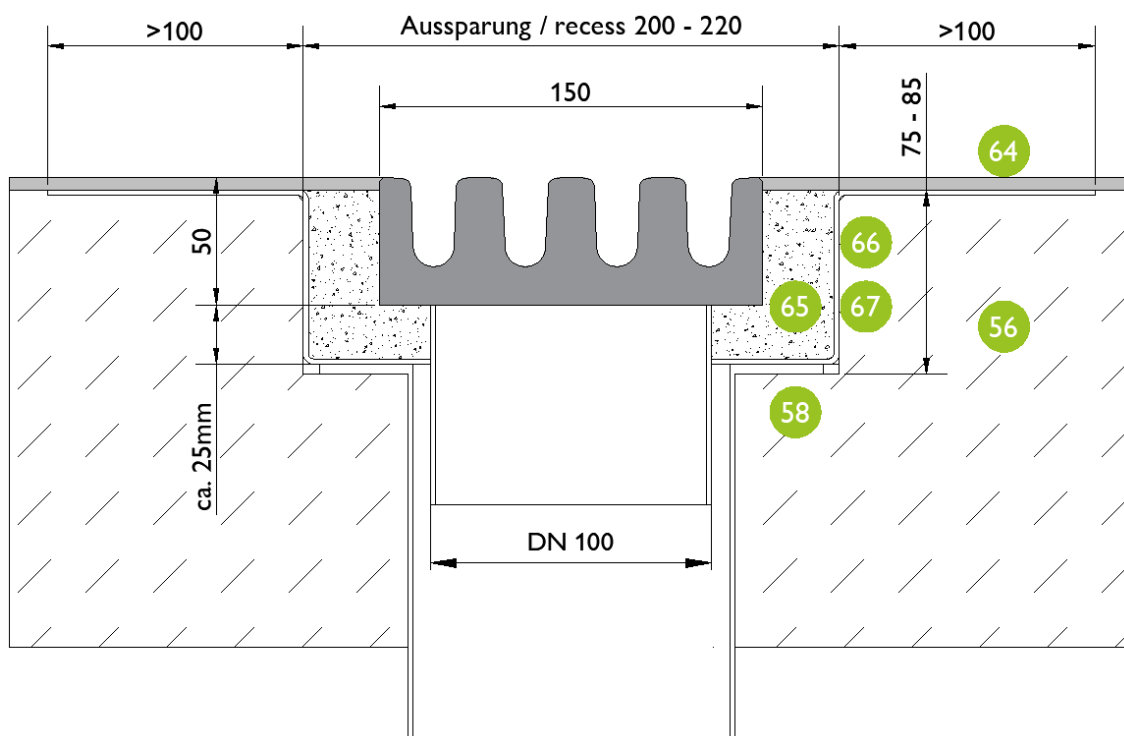

Legende / key:

- |     |   |     |  |
|-----|---|-----|--|
| 56. | Stahl-Betondecke / steel-reinforced concrete surface                        | 65. | Vergussmörtel / grout  |
| 58. | Rohrdurchführung mit Klemmflansch / pipes with trim ring                    | 66. | Grundierung / primer   |
| 64. | Beschichtung lt. Vorgabe Planer / coating according to planner requirements | 67. | Abdichtung vliesarmiert / building sealing with fleece reinforcement |

### Asphalt / asphalt: Kl. / cl. A - C

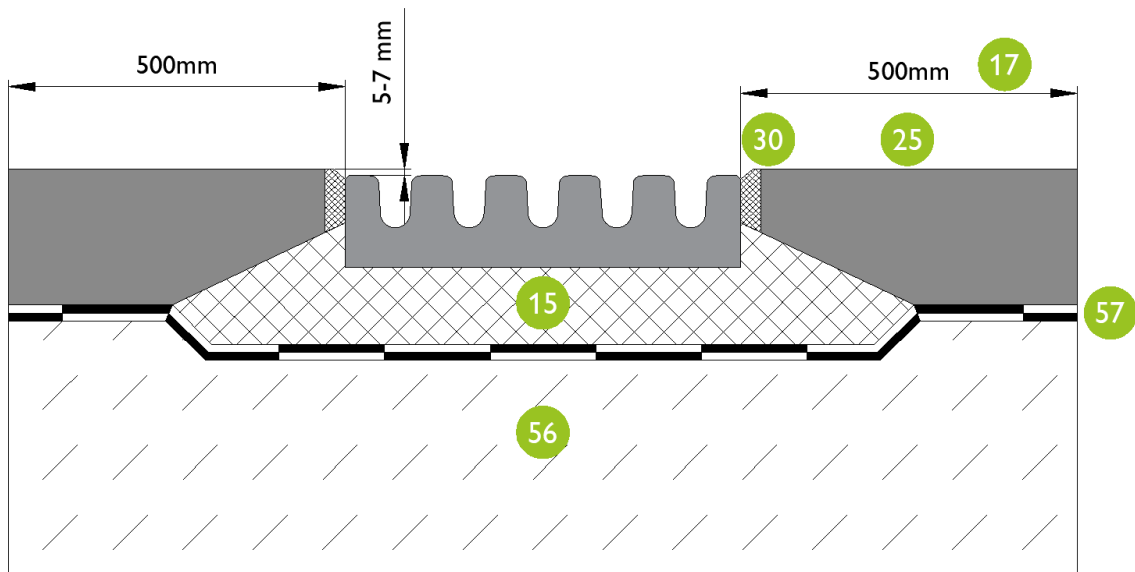

### Asphalt / asphalt: Kl. / cl. A - C

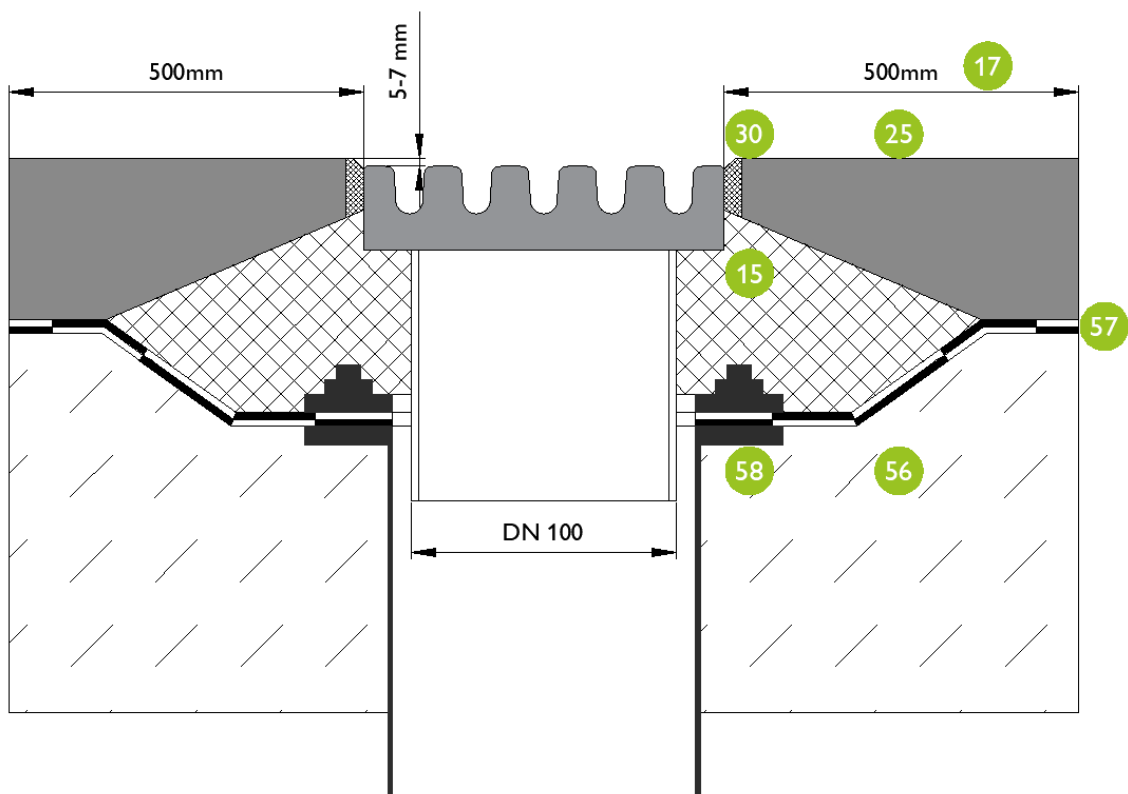

Legende / key:

- |   |  |
|---|--|
| 15. Drainagebeton / drainage concrete                               | 56. Stahl-Betondecke / steel-reinforced concrete surface     |
| 17. Verdichtung mit Rüttelplatte / compression with vibrating plate | 57. bituminöse Abdichtungsebene / bituminous sealing layer   |
| 25. Asphalt / asphalt   | 58. Rohrdurchführung mit Klemmflansch / pipes with trim ring |
| 30. bituminöses Fugenband / bituminous sealing tape                 |  |

### Guss-Asphalt / melted-asphalt: Kl. / cl. A - C

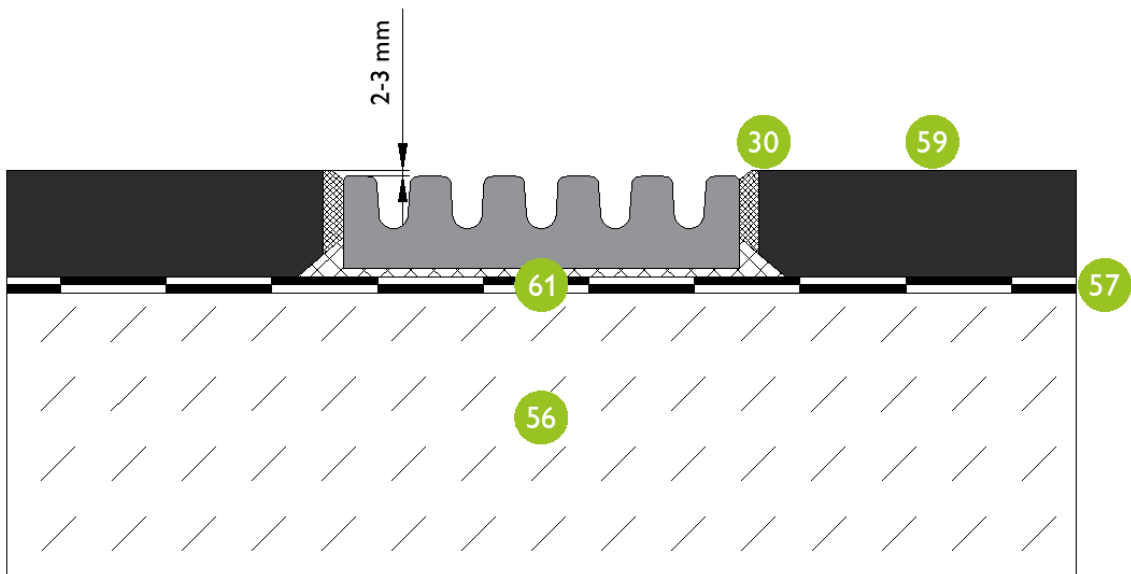

### Guss-Asphalt / melted-asphalt: Kl. / cl. A - C

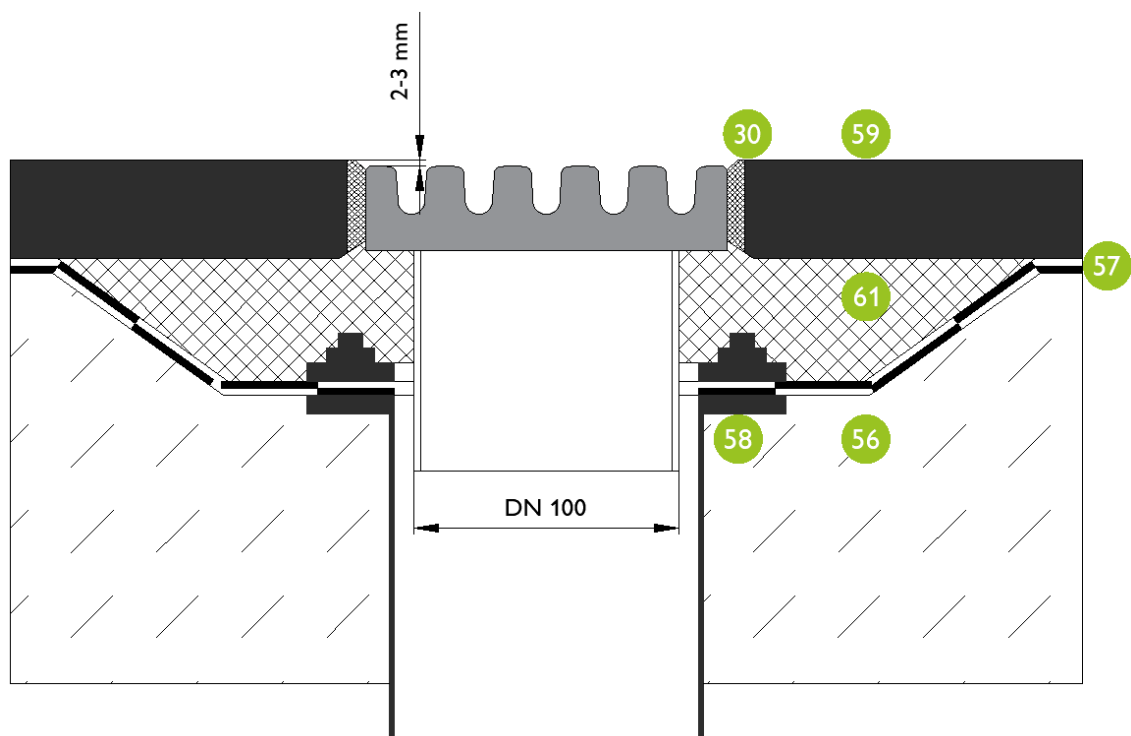

Legende / key:

- |     |  |     |  |
|-----|--|-----|--|
| 30. | bituminöses Fugenband / bituminous sealing tape        | 58. | Rohrdurchführung mit Klemmflansch / pipes with trim ring |
| 56. | Stahl-Betondecke / steel-reinforced concrete surface   | 59. | Gussasphalt / mastic asphalt                             |
| 57. | bituminöse Abdichtungsebene / bituminous sealing layer | 61. | Klebemörtel / adhesive mortar                            |

### Beton beschichtet / concrete coated: Kl. / cl. A - C

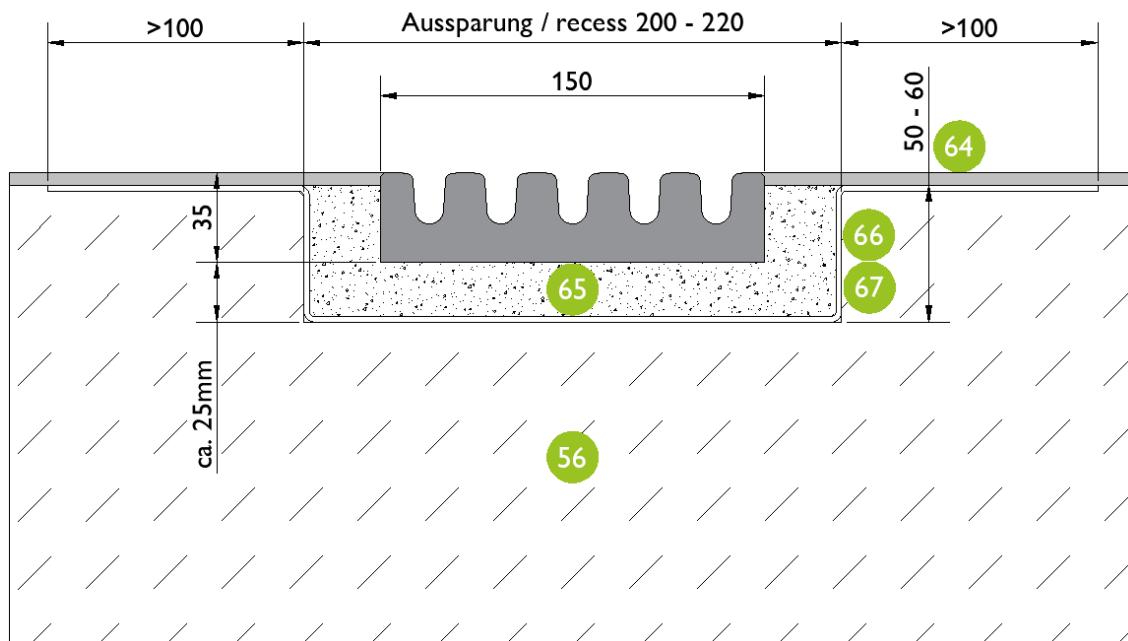

### Beton beschichtet / concrete coated: Kl. / cl. A - C

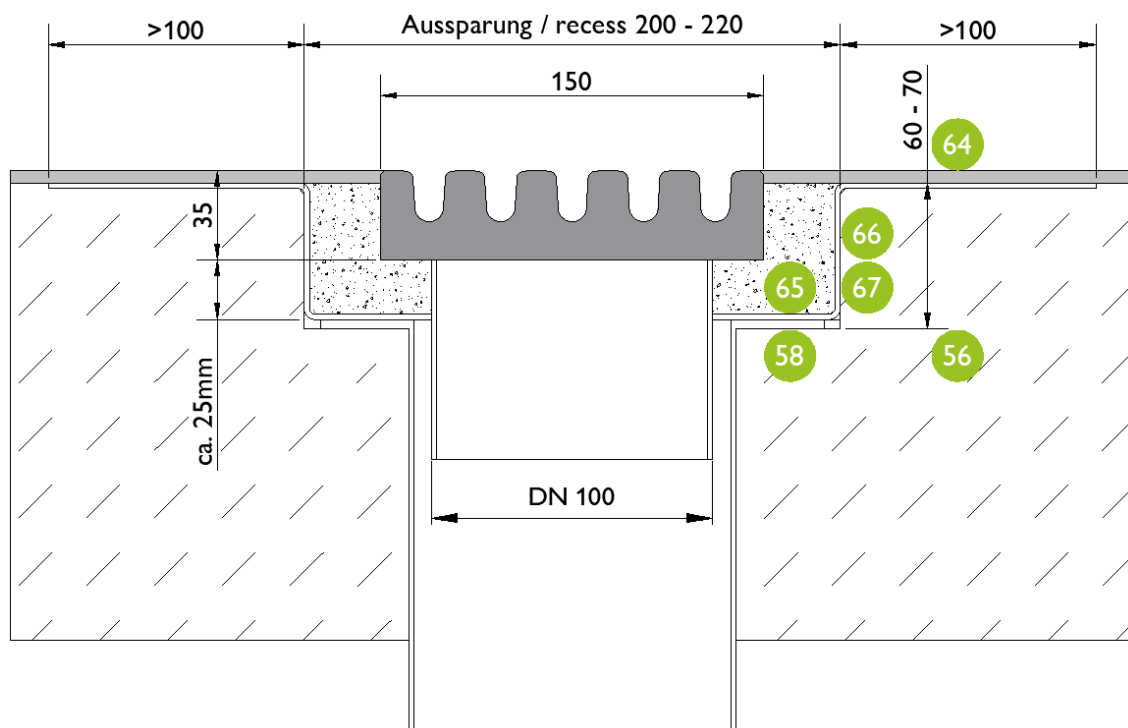

Legende / key:

- |     |   |     |  |
|-----|---|-----|--|
| 56. | Stahl-Betondecke / steel-reinforced concrete surface                        | 65. | Vergussmörtel / grout  |
| 58. | Rohrdurchführung mit Klemmflansch / pipes with trim ring                    | 66. | Grundierung / primer   |
| 64. | Beschichtung lt. Vorgabe Planer / coating according to planner requirements | 67. | Abdichtung vliesarmiert / building sealing with fleece reinforcement |